

TORQUE BLOCKER®

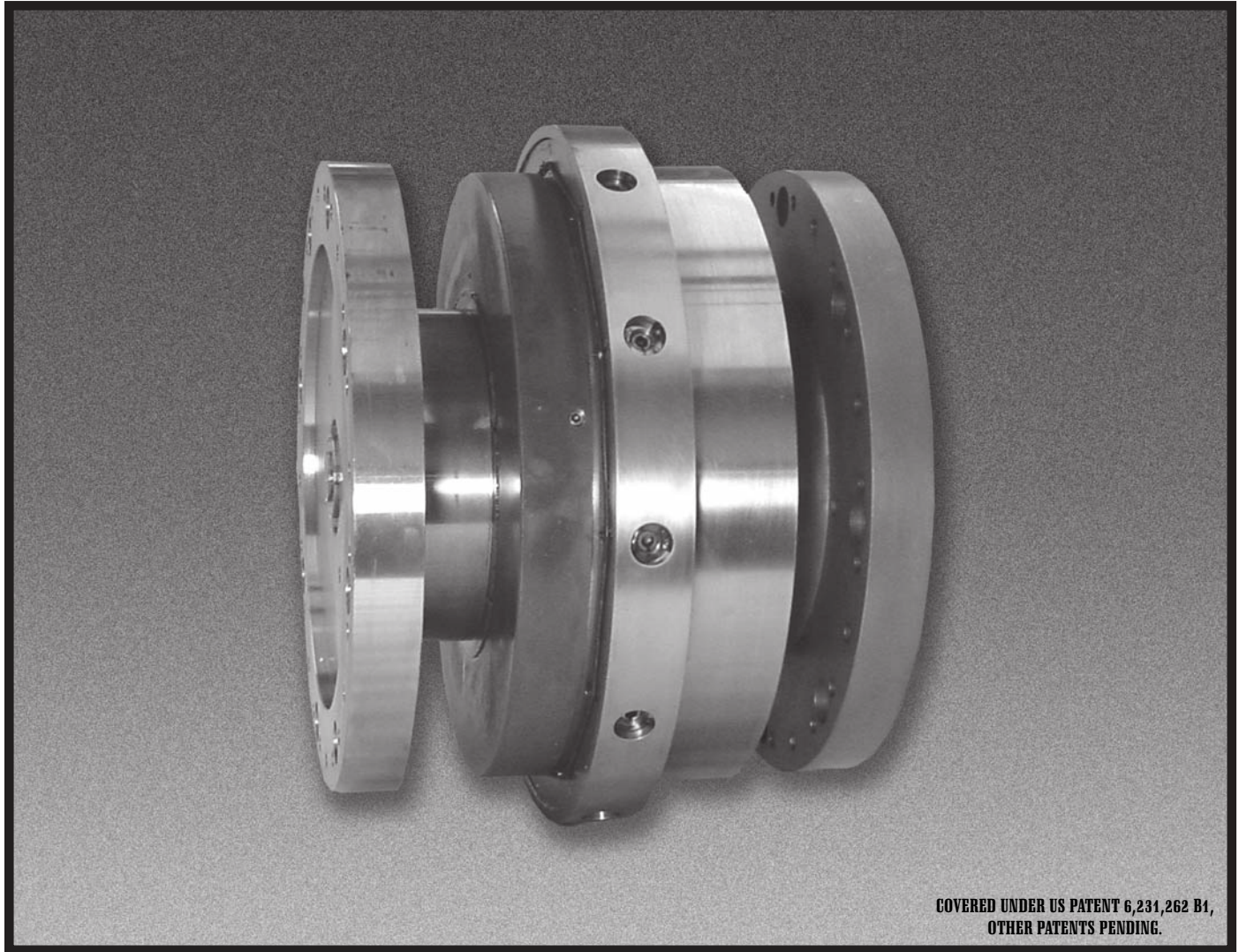

COVERED UNDER US PATENT 6,231,262 B1,
OTHER PATENTS PENDING.

Protect your critical heavy duty equipment with the Riverhawk Torque Blocker. The Torque Blocker fits within the coupling spacer that connects the shafts of drive and driven equipment. It protects equipment from torque

overload by releasing when a preset torque load is exceeded. Examples of overload are short circuit conditions in electric generators, running restart of electric motors, jams in rolling mills and liquid slugs in

compressors. After release, the Torque Blocker then allows machinery to safely coast down. Reset is simple and quick. Operators pump up the hydraulic clamp, reset the pins, drain the oil and reset is complete.

Advantages:

- Release is Independent of Direction
- Quick Release Safe Guards Against Severe Equipment Damage
- Rotates Freely Upon Release for Smooth Coast Down
- No Sacrificial Hardware to Replace
- Not Susceptible to Bending or Torque Fatigue
- No oil spray upon release
- Minimal reset time / Minimum loss of production



DESIGN AND OPERATION

The Riverhawk Torque Blocker connects in the shaft line with two flanges. One flange forms a stub shaft and the other forms a sleeve which surrounds the stub shaft. A hydraulic clamp is fitted around the sleeve. The unit is activated by applying hydraulic pressure to the clamp. This drives the two halves apart causing them to ride up the tapered outside diameter of a

collet. This results in a squeezing force that presses the sleeve down onto the stub shaft. The pressure between the sleeve and stub shaft defines the torque capacity of the unit.

Once pressurized, the radially mounted fuse pins are positioned under the teeth of the feedback ring. These pins hold the load in the clamp. The oil is

drained from the unit and it is now set and ready for service.

When a torque overload occurs, the sleeve slips on the stub shaft causing the feedback ring to rotate over the fuse pins allowing them to release from in-between the clamp halves. Torque is released and the stub shaft is now free to rotate within the sleeve for safe machinery coast down.

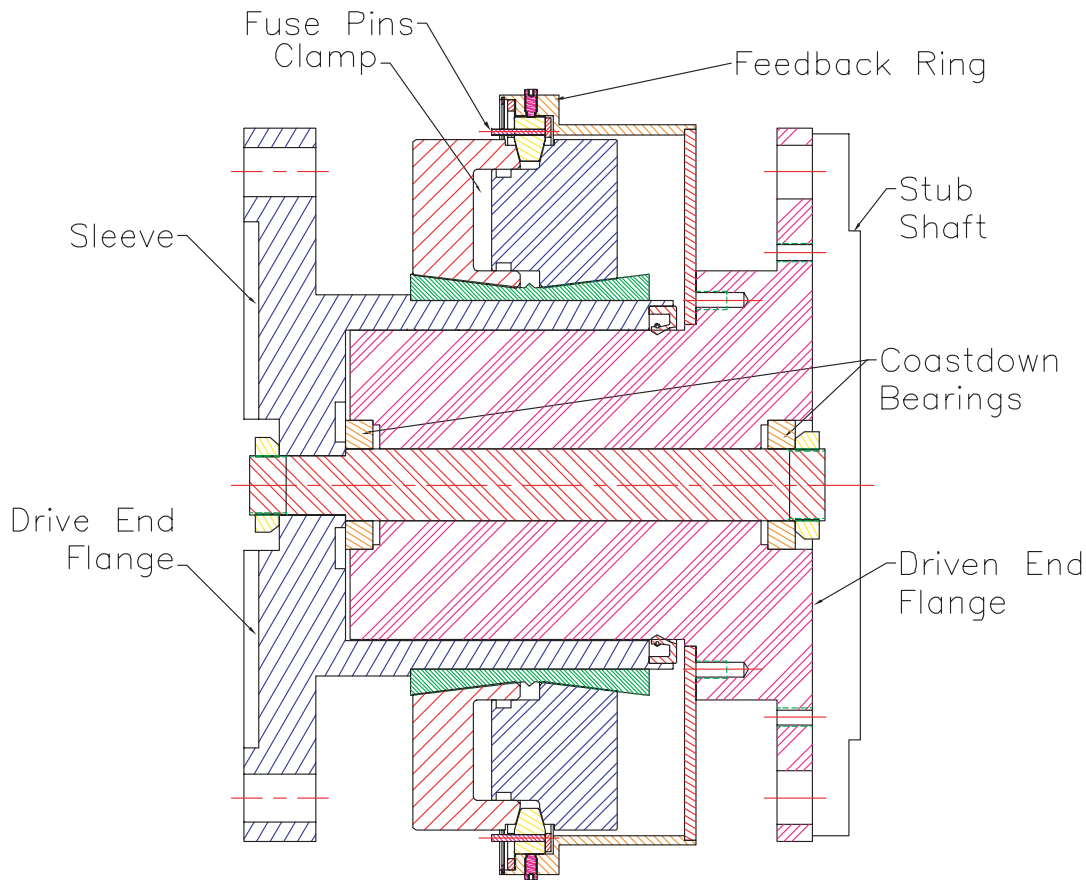

See website www.riverhawk.com for animation.

Riverhawk Company, an engineering driven manufacturer, specializes in hydraulic shaft joining technologies. We meet the daily challenges of the rotating equipment industry by offering auxiliary equipment such as air driven and manual hydraulic pressure kits and pusher piston cylinders for the installation of coupling hubs, thrust discs, and compressor wheels. Riverhawk also designs and manufactures hydraulically tensioned studs and nuts, tensioning tools, hydraulic nuts, and plug and ring gages. We also provide source inspections and training seminars. Our equipment is proudly supplied to the top OEMs and end users of the turbomachinery industry. Riverhawk is a member of the American Petroleum Institute (API) and sits on the coupling committee of the American Gear Manufacturers Association (AGMA).

For more information about Riverhawk's Torque Blocker or any of our other products and services call:



215 Clinton Road, New Hartford, NY 13413
Phone: 315-768-4855 Fax: 315-768-4941
sales@riverhawk.com <http://www.riverhawk.com>